

This up-to-the-minute, stylish upholstered seating is specifically designed to fulfil both the aesthetic and functional requirements of a contemporary reception space or waiting area.

Brick offers a variety of shapes for flexible and reconfigurable spaces.



Features

Standard Features

(*Selected models only)

- Traditional carcass construction
- Fully upholstered
- Plastic and Rubber glides*

Optional Features

(*Selected models only)

- Two-tone upholstery
- Choice of finish options available
– see finish page

Finishes

Steel legs available in Black powder coat

Brick can be upholstered in a broad range of contract upholstery fabrics and vinyls from The Senator Group standard upholstery collection

Metal Frame Finishes



Black
(Powder Coat)

BR1

Overall Height: 465mm
Overall Width: 400mm
Overall Depth: 400mm



BR2

Overall Height: 465mm
Overall Width: 600mm
Overall Depth: 400mm

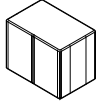

BR3

Overall Height: 465mm
Overall Width: 100mm
Overall Depth: 400mm

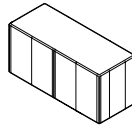

BR4

Overall Height: 465mm
Overall Width: 1200mm
Overall Depth: 400mm

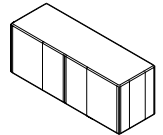

BR5

Overall Height: 465mm
Overall Width: 180mm
Overall Depth: 400mm

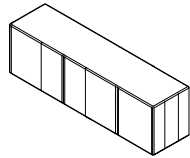

BR2B

Overall Height: 600mm
Overall Width: 600mm
Overall Depth: 200mm



BR3B

Overall Height: 600mm
Overall Width: 1000mm
Overall Depth: 200mm

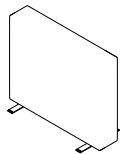

BR4B

Overall Height: 600mm
Overall Width: 1200mm
Overall Depth: 200mm

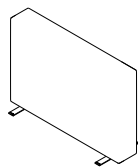

BR5B

Overall Height: 600mm
Overall Width: 1800mm
Overall Depth: 200mm

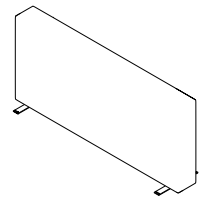

BRQ1

Overall Height: 465mm
Overall Width: 1200mm
Overall Depth: 540mm

